

Parts List

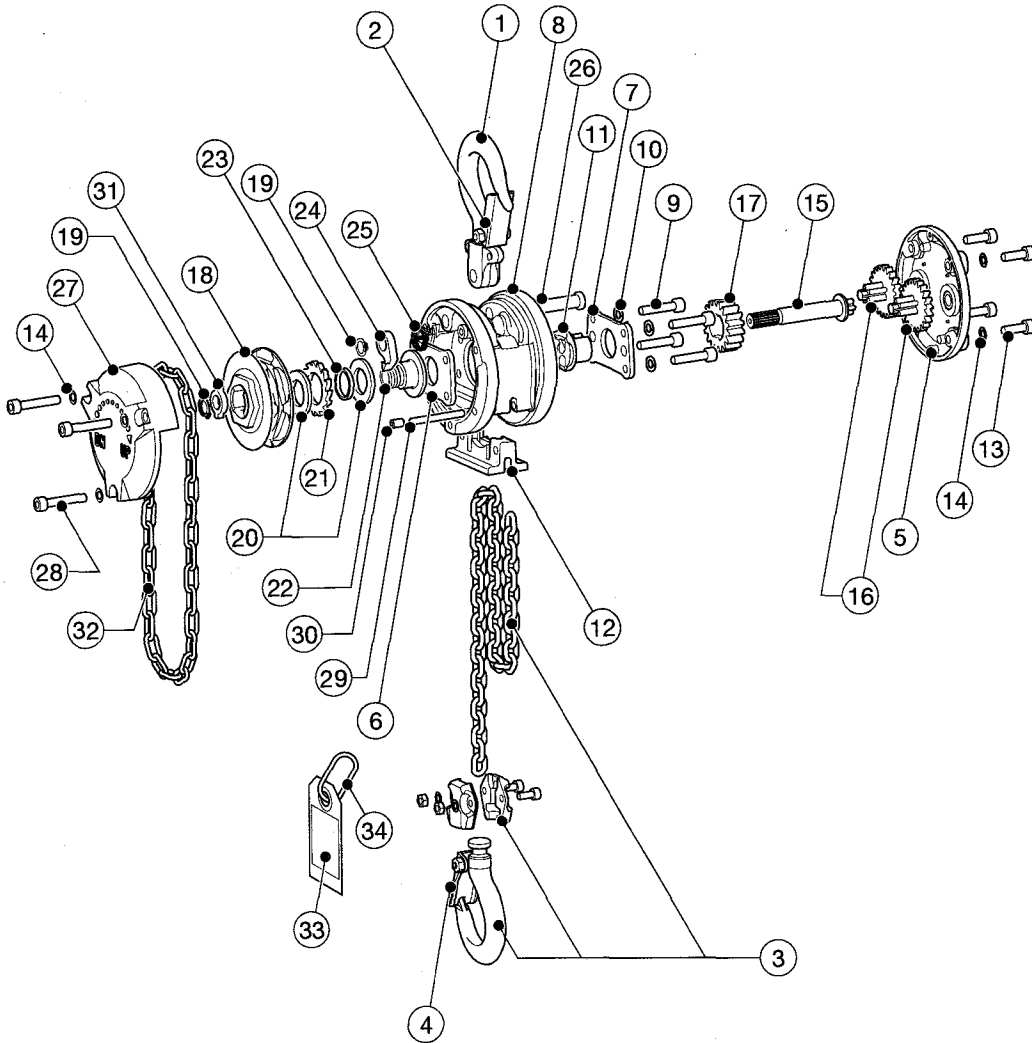

| Fig. No. | Part No. | Part Name | Parts per Unit | Part code | Application |
|----------|----------|-----------------------------|----------------|--------------|-------------|
| 1 | 1001 | Top Hook Set | 1 | L1XA003-1001 | |
| 2 | 071 | Latch | 1 | L1XA003-1071 | |
| 3 | 1011 | Bottom Hook Complete Set | 1 | C1XA003-1011 | |
| 4 | 071 | Latch | 1 | L1XA003-1071 | |
| 5 | 5103 | Gear Case Assembly (Europe) | 1 | C1XG003-5103 | |
| 5 | 5103 | Gear Case Assembly (Other) | 1 | C1XD003-5103 | |
| 6 | 101 | Frame A | 1 | C1XA003-9101 | |
| 7 | 102 | Frame B | 1 | C1XA003-9102 | |
| 8 | 6104 | Body Assembly | 1 | C1XA003-6104 | |
| 9 | 106 | Socket Head Cap Screw | 4 | J1BE9-050252 | |
| 10 | 107 | Spring Lock Washer | 4 | J1WS011-2005 | |
| 11 | 116 | Load Sheave | 1 | C1XA003-9116 | |
| 12 | 162 | Chain Guide | 1 | C1XA003-9162 | |
| 13 | 108 | Socket Head Cap Screw | 4 | J1BE3-050151 | |
| 14 | 109 | Conical Lock Washer | 7 | C1XA003-9109 | |
| 15 | 111 | Pinion | 1 | C1XA003-9111 | |
| 16 | 112 | Gear #2 | 2 | C1XA003-9112 | |
| 17 | 114 | Load Gear | 1 | C1XA003-9114 | |

| Fig. No. | Part No. | Part Name | Parts per Unit | Part code | Application |
|----------|----------|---------------------------|----------------|--------------|-------------|
| 18 | 5115 | Hand Wheel Assembly | 1 | C1XA003-5115 | |
| 19 | 117 | Snap Ring | 2 | J1SS000-0000 | |
| 20 | 151 | Friction Plate | 2 | C1XA003-9151 | |
| 21 | 152 | Ratchet Disc | 1 | C1XA003-9152 | |
| 22 | 153 | Friction Disc | 1 | C1XA003-9153 | |
| 23 | 154 | Bushing | 1 | C1XA003-9154 | |
| 24 | 155 | Pawl | 1 | C1XA003-9155 | |
| 25 | 158 | Pawl Spring Assembly | 1 | C1XA003-5179 | |
| 26 | 163 | Top Pin | 1 | C1XA003-9163 | |
| 27 | 171 | Wheel Cover | 1 | C1XA003-9171 | |
| 28 | 176 | Socket Head Cap Screw | 3 | J1BE3-050302 | |
| 29 | 177 | End Pin | 1 | C1XA003-9177 | |
| 30 | 178 | Hexagon Socket Set Screw | 1 | J1TB011-0500 | |
| 31 | 203 | Cam Guide | 1 | C1XA003-9203 | |
| 32 | 842 | Hand Chain | 1 | K7SX025-0000 | |
| 33 | 868 | Warning Tag CE-G (Europe) | 1 | ER1BS9686 | |
| 33 | 868 | Warning Tag CE (Other) | 1 | E7AP003S9886 | |
| 34 | 045 | Chain Stopper Link | 1 | LSBA008-9045 | |